

PSE 101

Welcome to Providence Spring Elementary!

10045 Providence Church Lane

Charlotte, NC 28277

Ph: 980-343-6935

Jane Armbruster, Principal

Linda O'Connor, Assistant Principal

Bell: 8 am - 3 pm

PSE 101 Quick Reference Guide

- **PSE Webpage**

<http://schools.cms.k12.nc.us/providencespringES/Pages/Default.aspx>

General PSE and CMS information, Grade Level pages, links to PayPams, CMS forms and Listserv sign up.

- **PSE PTA**

<http://providencespringpta.weebly.com/>

PTA Board and meeting information, Volunteer Opportunities, Rocket Review Issues (monthly newsletter), Pay4SchoolStuff (Spirit Wear, Rock, Yearbooks, School Fees)

- **PSE Facebook Page:** <https://www.facebook.com/ProvSpringPTA/>

- **PowerSchool:** <https://cms.powerschool.com/public/>

Access to online grades and attendance records (Grades 3-5)

PSE 101 Quick Reference Guide

What is PAIDEA?

PSE is a National Paideia School. Paideia comes from the ancient Greek word for “the upbringing of a child”. Paideia schools actively engage students by teaching them to think critically. Seminars involve teaching through open-ended questions which facilitates a collaborative dialog about a text.

For more information visit www.paideia.org

Outdoor Learning Classroom

PSE’s 23 acre campus is one of the things that makes the school so special. The school has been designated a “School Yard Habitat” by the National Wildlife Federation. The largely undeveloped land, as well as the close proximity to the historic Providence Presbyterian Church grounds provide a unique learning opportunity for our students.

Student ID

CMS will send you your child’s student ID number when you register for school. Please keep track of this number, as it will stay with your child through their time in CMS, and will be needed for a variety of reasons (PayPAMS, transportation changes, PowerSchool, etc.)

PSE 101 Quick Reference Guide

Lost & Found

PSE has a Lost & Found located outside the gym. Your child can check it during the day, or parents can check in when they are on campus.

Be sure to **label everything!** Lunch boxes, water bottles, coats, hats, etc. If an item is found and is labeled it can easily be returned to the student it belongs to!

Did your child forget something at home? Take it to the main office to be delivered to your child's classroom. Please be sure to label it with their name and teacher's name.

Absences, Late Arrivals, Early Dismissals

Illnesses are a part of elementary school life. If your child will be absent, please email pseabsent@cms.k12.nc.us as well as your child's teacher. You can also call the school office.

For excused late arrivals or early dismissals (doctor/dentist appointments), report to the office and complete the sign in/out card for your students. Office staff will have a volunteer accompany your child to class or have your child accompanied to the office to meet you. Never go to the classroom to pick up your child, or have them enter the building without you. ***Please note that any early dismissal must be completed by 2:30.***

Getting In & Out

- PSE has many volunteers and visitors each day. For safety purposes, everyone must report to the office and everyone (teachers, visitor and students) **MUST** wear a name badge.
- PSE's front doors will be locked during school hours. Upon arrival, push the call button outside the front door, and state your purpose for visiting (lunch, volunteering, etc.) When you are buzzed in please go directly to the office to sign in. **Be sure to have your drivers license with you.** Sign it at the computer in the office, and attach a visitors badge in a visible place.
- Be sure to sign out when you leave.
- For school events that take place outside of school hours (Family Night Dinner, Gallery Walk, etc.) you do not need to sign in.

Transportation

BUS INFORMATION

- Always arrive at your bus stop 5 minutes early. You will not be notified if your child misses the bus.
- If you have questions or concerns about your specific bus or driver, please contact Traci Rider @ t.folk@cms.k12.nc.us . For general transportation concerns, contact the South Transportation Area Office at 980-343-5715 or transportation@cms.k12.nc.us.
- To receive updates regarding bus changes or delays, follow us on twitter. @psebuses

GENERAL CARPOOL INFORMATION

- At the entrance, take turns letting cars in from both directions to avoid traffic back up.
- The center lane is for buses only.
- Do not block the thruway (located by the school rock).
- Carpool can be very crowded on rainy days or the days before and after a long weekend or holiday. Allow extra time on these days.

Transportation

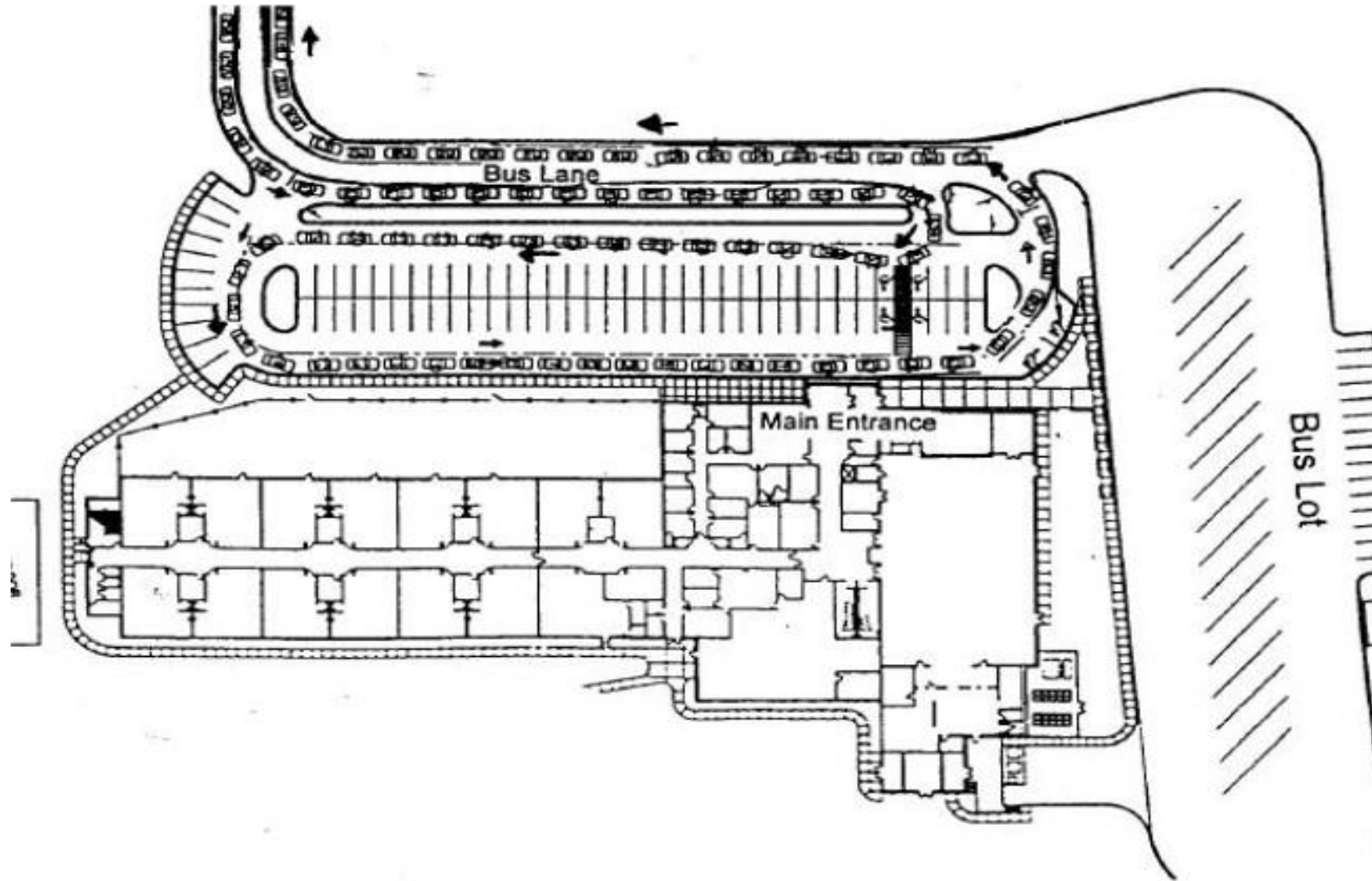

Transportation

MORNING CARPOOL

- Remember to allow time for your child to walk to class, put their things away and be in their seat when the bell rings at 8:00. If your child is tardy, please accompany them into the front office and sign them in.

AFTERNOON CARPOOL

- If you pick your child up every day, you should have a car tag. Please contact Phyllis Berlacher: phyllis.berlacher@cms.k12.nc.us to obtain a car tag.
- If your child typically rides the bus, you can still pick up in carpool any time. Be sure to send a written note to your child's teacher that morning. If you need to make a change during the school day, contact the front office to have your child's teacher notified.
- Do not email transportation changes (unless they are permanent) to your child's teacher- always send them in writing.
- Be patient and accommodate parents and staff leaving the school while lined up for carpool. *(If you are leaving the school at the end of the day, it can be very difficult to exit the parking lot once carpool has begun. Try to leave before the dismissal bell rings).*

PSE is a green school. Please turn your vehicle off when possible.

Snack Time

- PSE sees snack time as an important part of your child's day- refueling is essential for elementary age students.
- This is a working snack time. Pack healthy snacks that are easy to open and eat. Try to avoid snacks that require utensils or could be messy (yogurt, juice, etc.)
- Try to avoid snacks with peanuts. Even if your class does not have students with nut allergies, other students or staff may enter that classroom and be exposed.
- Make sure snacks and water bottles are packed separately from lunch.

Breakfast

Each morning, PSE offers “universal” free breakfast. This meal is free for all students. It includes milk, fresh fruit, fruit juice, grain – 1 serving, 2nd grain or meat option – 1 serving.

- One hot breakfast item is offered each day (i.e., sausage pancake on a stick, mini French toast, breakfast pizza, chicken biscuit, turkey ham and cheese roll.)
- Cold breakfast items offered every day include: cereal (Trix, Cinnamon Toast Crunch, Cheerios or Chex) Yogurt, Graham crackers, apple sauce, cereal bar, cheese stick, bananas, blueberry muffins, fresh fruit.

Students who travel via carpool should arrive in the cafeteria no later than 7:45 to allow enough time to travel through the line, eat, and walk to class before the bell at 8:00. If children travel via bus, they are able to eat when the bus arrives.

Students are to report directly to the cafeteria, eat, then travel to their classroom.

Students are required to eat their breakfast before shopping at the school store. No school store items are permitted at the breakfast tables.

Lunch

Lunchtime lasts for 25 minutes. If you are packing your child's lunch, be sure he or she can independently open all items. Use reusable containers when possible.

Buying Lunch

- Access the breakfast/lunch menu via the CMS Child Nutrition Services page: www.cms.k12.nc.us/cmsdepartments/cns or the PSE Rocket Café Page.
- For lunch to cost \$2.85, student must take a main item, one fruit, 1-2 vegetables and milk. Any other combination is considered a la cart and more expensive.
- PayPams allows you to pay for and track your child's meal purchases: www.paypams.com.
- Kindergarten students are allowed to purchase dessert only on Fridays.

Students may have a visitor (parent, siblings, grandparents, etc.) join them for lunch. Follow normal check in procedures at the front office, then go to the cafeteria to wait for your child. If the class table is full, you may move to a back table. Bring lunch from home or purchase from the Rocket Café and pay with your child's PayPams account. No food from outside vendors (i.e., fast food) is allowed.

Class lunch schedules are listed on the Rocket Café page.

We Love Volunteers!

All volunteers must be registered with CMS in order to volunteer on campus.

Visit www.CMSVolunteers.com Click “New Volunteer? Click Here to Register” and complete the form.

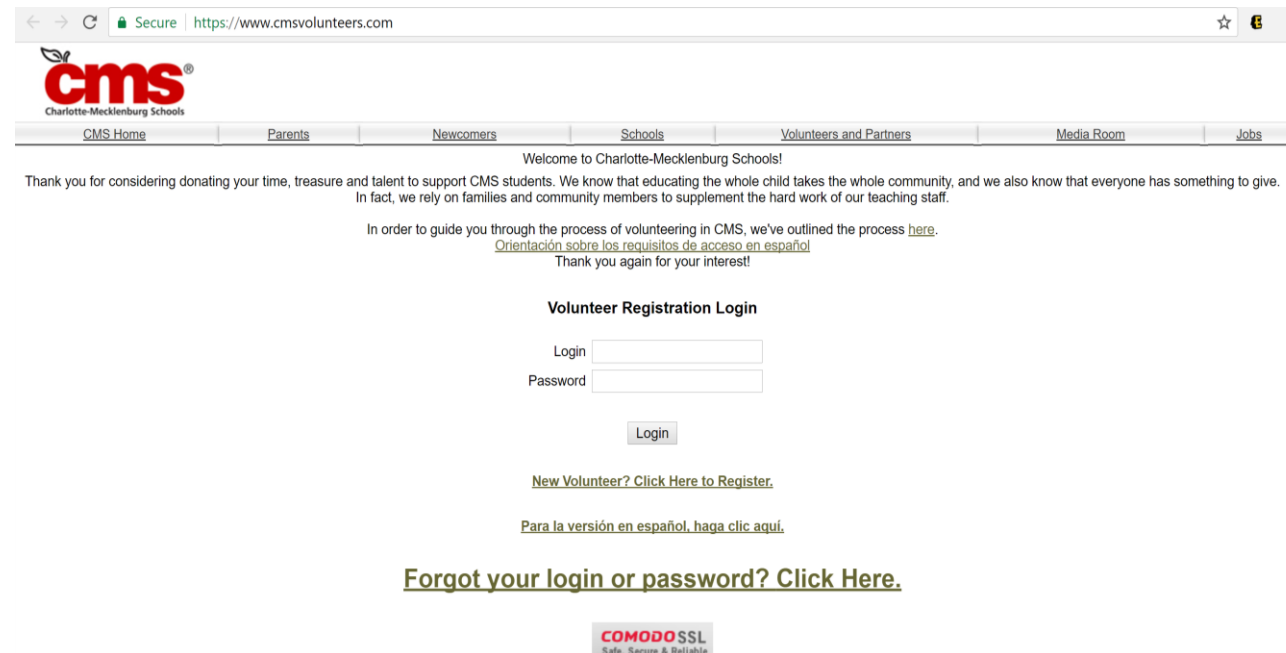

The screenshot shows a web browser window with the URL <https://www.cmsvolunteers.com>. The page features the CMS logo (Charlotte-Mecklenburg Schools) and a navigation menu with links for CMS Home, Parents, Newcomers, Schools, Volunteers and Partners, Media Room, and Jobs. The main content area includes a welcome message, a link to the registration process, and a login form for existing volunteers. The login form has fields for Login and Password, and a Login button. Below the login form, there are links for new volunteers to register and for users to access the Spanish version of the site. At the bottom, there is a link for users who forgot their login or password.

Welcome to Charlotte-Mecklenburg Schools!
Thank you for considering donating your time, treasure and talent to support CMS students. We know that educating the whole child takes the whole community, and we also know that everyone has something to give. In fact, we rely on families and community members to supplement the hard work of our teaching staff.

In order to guide you through the process of volunteering in CMS, we've outlined the process [here](#).
[Orientación sobre los requisitos de acceso en español](#)
Thank you again for your interest!

Volunteer Registration Login

Login

Password

Login

[New Volunteer? Click Here to Register.](#)

[Para la versión en español, haga clic aquí.](#)

[Forgot your login or password? Click Here.](#)

COMODO SSL
Safe. Secure & Reliable

We Love Volunteers!

In Class Volunteer Opportunities

Classroom Celebrations * Math/Literacy (varies by grade level) *
Character Education * Art Appreciation * Junior Achievement
(varies by grade level)

Additional Opportunities

Book Fair (Fall and Spring) * Field Day * DadCorps * Book Swap *
Yearbook * Beautification * Media Center * Tutors *
Fall Carnival * And More!

PSE Celebrations

BIRTHDAYS

- You have the option to order a lunchtime birthday dessert for your child's class from the cafeteria by filling out the "Celebrate your birthday with us" form located on the Rocket Café webpage. Outside food may not be brought in to the cafeteria or classroom.
- Join your child for lunch on their birthday. Your birthday treats, ordered from the cafeteria, will be delivered to your child's table. Students and parents may pass them out to classmates.
- Sign up to paint the rock! The cost is \$10. Sign up and pay on www.Pay4schoolstuff.com.

CLASSROOM CELEBRATIONS

- Each celebration may have 4 parent volunteers. Please do not put your teacher in an uncomfortable situation and come to the celebration if you are not one of the 4 volunteers.
- Volunteering is fun, but plan to be busy with set up, clean up and an activity station. Siblings should not come with you when you volunteer.
- *If you have already volunteered, step back and allow other parents to have a turn unless you are asked to fill in .*

Fun Stuff at School

School Store

- Open Tues. & Thurs. 7:25-7:55. Located in front of the cafeteria.

Cafeteria Concerts

- Students may sign up to perform (singing or playing an instrument). Watch the Rocket Review for sign up information.

Spirit Week

- Students wear a designated item each day to show school spirit. Watch for announcements in the Rocket Review.

Staff Appreciation Week

- A week of honoring our staff. Room parents coordinate volunteers and donations.

Events & Happenings

- **Fun Run-** Returning this fall to PSE! Stay tuned for more details!
- **Book Fairs (Fall and Spring)** – School fundraiser where several books and other items are sold in the media center. Parents and siblings are invited to come shop with their student’s class.
- **Fall Family Night Dinner** – Held in conjunction with the Fall Book Fair, all PSE families are invited to come have dinner at PSE (pizza) and shop at the Book Fair.
- **Spring Ice Cream Social** – Held in conjunction with the Spring Book Fair, all PSE families are invited to come have ice cream and shop the Book Fair.
- **Rocket Art** – Fall fundraiser featuring student artwork transferred onto various gift items (key chains, pillowcases, notecards, necklaces etc.).
- **Rocket Raffle** – School wide fundraiser featuring creative items or experiences from each person on staff at PSE. Raffle tickets are sold for each item/experience, winners are chosen at random and announced at the end. This is a popular PSE tradition with both students and parents!
- **Gallery Walk** – This special spring evening fundraiser, held at PSE includes all PSE students. Families may purchase their budding PSE artists' masterpieces with all proceeds supporting the art, music and PE programs and PSE.
- **Reflections** - Annual NC PTA student art competition open to all students.
- **Fall Carnival** – This free Saturday morning event includes games, bounce houses, a bungee jump and food plus the very popular Teacher Pet Parade. All PSE families are welcome.
- **Field Day** – Each grade level participates in outdoor games and activities.
- **Celebration of Nations** – This popular school wide event celebrates customs and traditions around the world
- **Spirit Night-** Join other PSE families for a fun family outing at a Checkers game and Hornets game.

Clubs

- Percussion
 - Choir
 - Chimes
 - Quiz Bowl
- Mystery Club
- Science Olympiad
 - Chess Club
- Environmental Club
 - Character Club
- Jump Rope Team
 - Flag Patrol

- Xcel 2 Fitness
- Running Club
- Safety Patrol
 - WE Rock
- Drama Club
 - Robotics

Club participation varies by grade level. Information will be sent home prior to clubs starting.

Siblings Are Part of PSE Too!

There are many occasions when we welcome siblings at PSE. However, they are never allowed in the classrooms. Plan on bringing any family members to the following PSE events:

- Fall Carnival
- Gallery Walk
- Ice Cream Social
- Family Night Dinner
- Lunch Daily

If you are not sure if you can bring a younger sibling to an event, meeting, etc. always ask.

A quick call to the office or an email to a teacher is best!

Welcome to PSE, we are glad you're here!

If you have any questions, or would like to be matched with a Parent Ambassador, please contact Chrystal Bachmann at cbachmann@carolina.rr.com